

Compliances:

- ETL Verified FAA L-810 to AC 70/7460-1, Obstruction Marking and Lighting at -55°C to +55°C
- Compliance with ICAO Annex 14 Low Intensity Types A & B
- Registered ISO 9001: 2022

OB.Light red steady-burning obstruction lights are used to mark tall structures that present hazards to air navigation. During the night, these lights warn pilots to stay clear of the obstruction when installed in accordance with FAA AC 70/7460-1 and applicable FAA and ICAO Annex 14 Low Intensity Types A & B rules and recommendations. Together with the flashing FAA L-L-810 (F) flashing red obstruction light, which operates at 30 flashes per minute (FPM), and BSE controllers, the BSE OB.Light contributes to an integrated lighting system. When applied individually, single and double BSE OB.Lights mount directly to conduit risers and may be combined with a BSE controller's universal transfer & alarm relay for lamp backup and remote lamp failure alarm indication. Typically, one photoelectric controller is sufficient to provide automatic lighting activation at dusk in accordance with FAA specifications. All BSE OB.Lights include lens tethers. The power consumption does not exceed 5 to 7 Watts per head.



Single Types

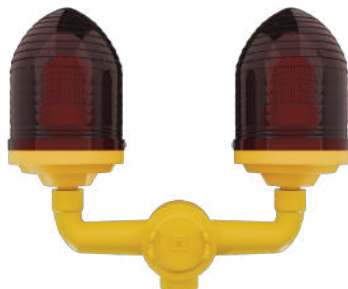

Double Types

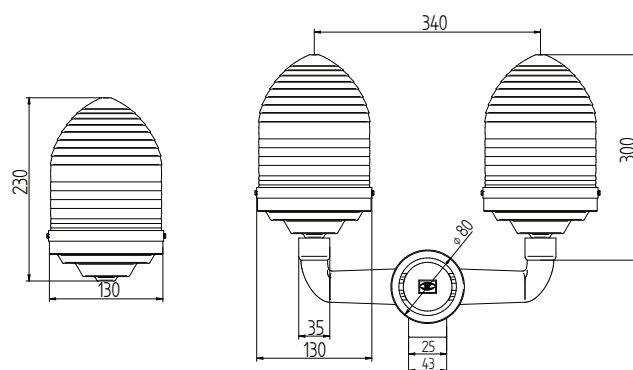

Dimension

Features:

- Accepts traffic signal lamps with E27 base
- Operating voltage on 120 or 220 Vac 50-60 Hz power supply when used with proper voltage lamp
- Temperature range at -20° c to + 60° c
- Red color Acrylic lens globes for 360° visibility
- Yellow color ABS base
- Three way junction box cast iron body ; double only
- Threaded hub ( 3/4- inch ) for mounting ; double only

MODEL:BSPL



B.S.E Type	Power	Specification	Lens Color	Style
BSPL1220R5E27	220V AC 5Watts	FAA L-810 &	<div style="background-color: red; color: white; text-align: center;">RED</div> <div style="background-color: white; color: black; text-align: center;">Clear</div>	Single Types
BSPL2220R5E27		ICAO Low Types A		Double Types

5w

Lifespan of the red LED light bulb is 4,000 hours at 120 Volts or 8,000 hours at 220-240 Volts. For LED lamp usage, the lifespan exceeds 100,000 hours. Accepts traffic signal lamps with USA medium screw base and European **E27 base**.



B.S.E Type	Power	Specification	Lens Color	Style
BSPL1220F7	220V AC 7Watts	FAA L-810 &	<div style="background-color: red; color: white; text-align: center;">RED</div>	Single Types
BSPL2220F7		ICAO Low Types A		Double Types

7w

Lifespan of the warm white LED light bulb is 4,000 hours at 120 Volts or 20,000 hours at 220-240 Volts. Accepts traffic signal lamps with USA medium screw base and European **E27 base**.

## OB.LIGHT CONTROL

"B.S.E Electronic Co., Ltd. specializes in the manufacturing of aviation obstruction light controllers. Our controllers are available in a variety of models, each designed to accommodate different levels of obstruction light installations. We offer options for input voltages of either 220V AC or 48V DC, ensuring compatibility with diverse power systems. Our company is dedicated to providing reliable solutions tailored to meet the specific requirements of our customers."



Example picture of control cabinet

## FAA configurations

### FAA RED lighting Type A-Painted Tower / RED lights for night

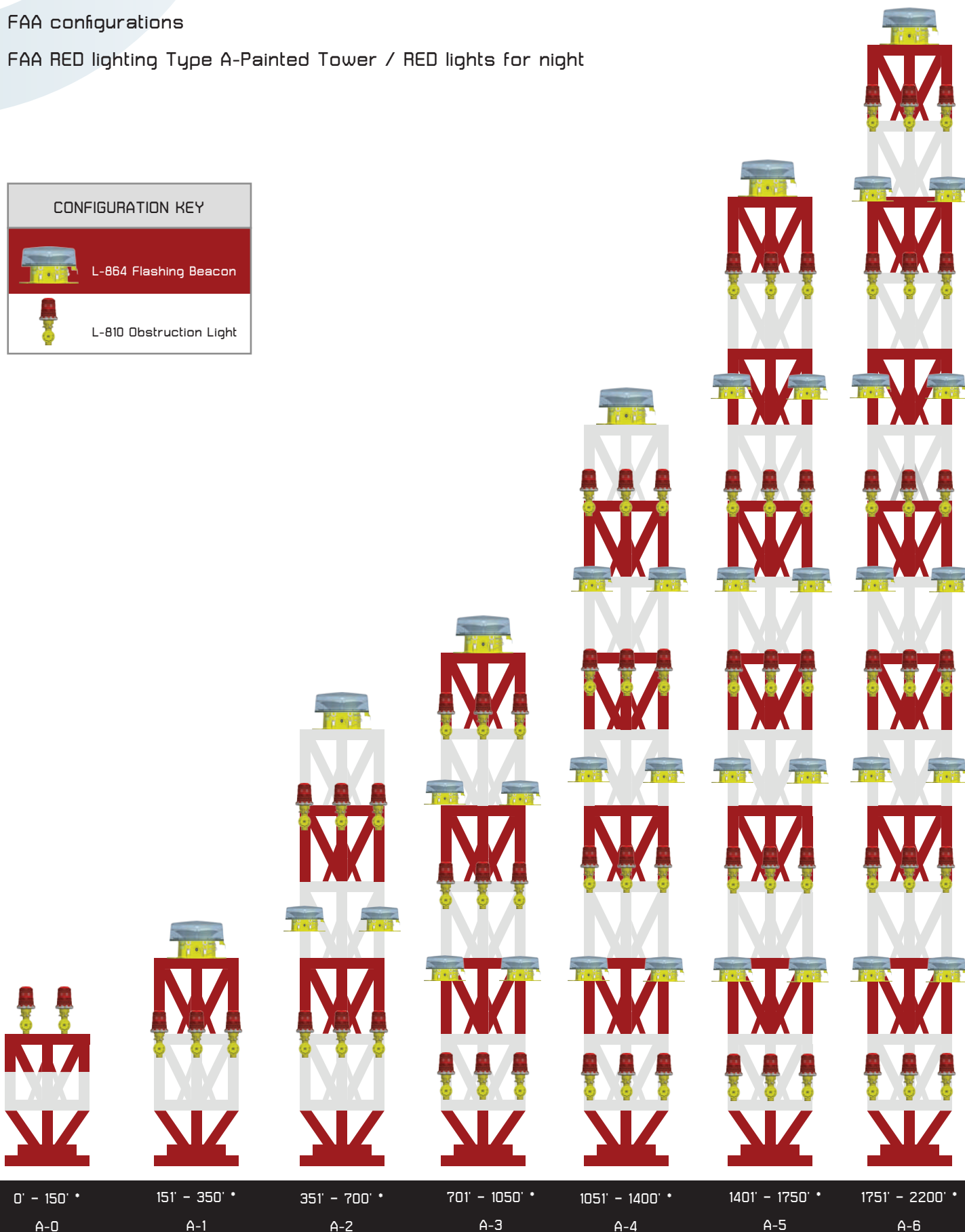

## Installation Guidelines for Obstruction Signal Lights by B.S.E Electronic Co., Ltd.

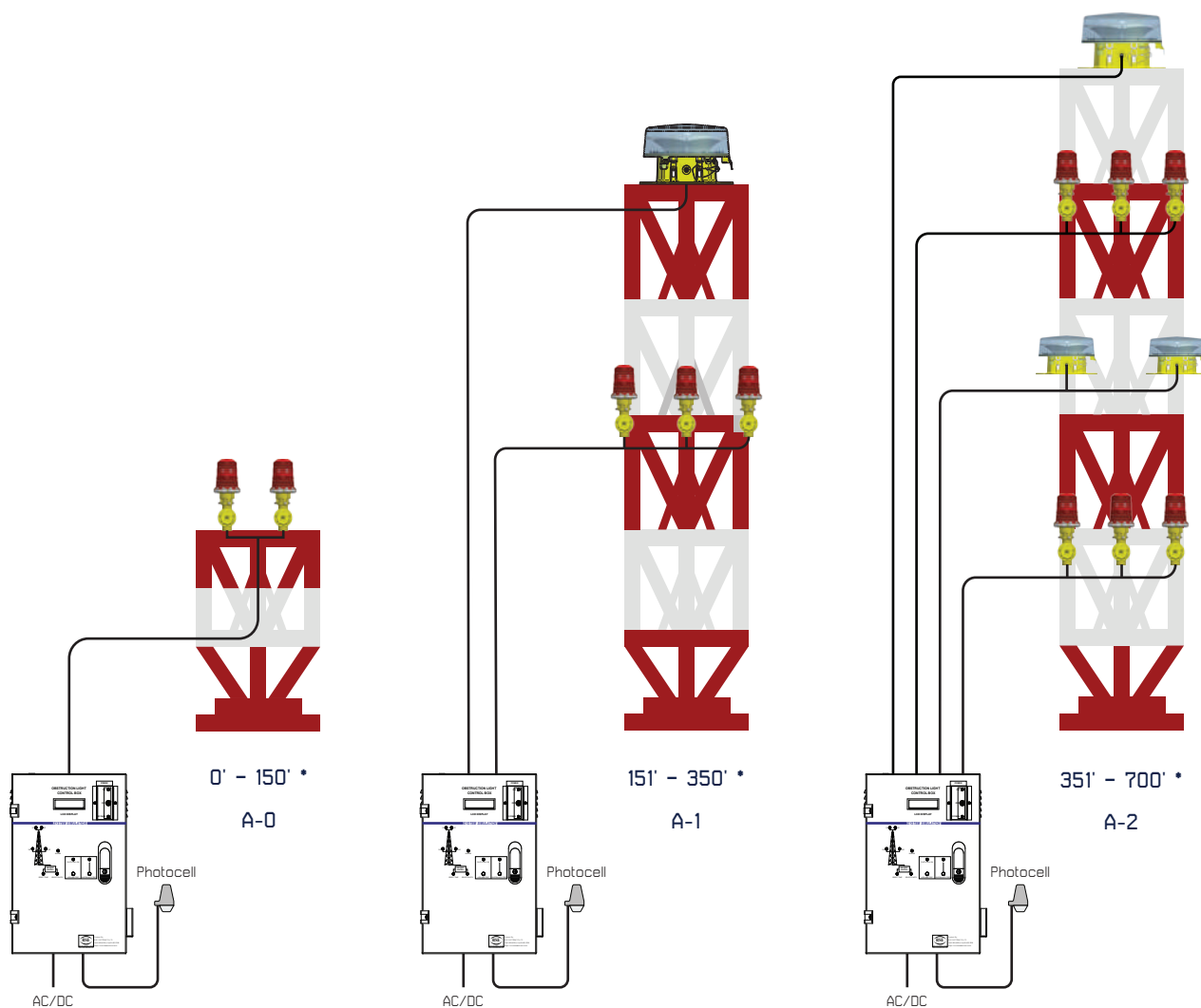

### OBSTRUCTION LIGHT CONTROL



#### BSCB

Control cabinet for lights with 3 outputs

Operation modes:

Flashing / Steady / Single Light On with  
One Light Backup



#### TS1

Control cabinet for lights with 3 outputs

Input 48v DC

Operation modes: Flashing / Steady



#### TS3

Control cabinet for lights with 1-16 outputs  
(depending on the height of the building  
installation)

Operation modes: Flashing / Steady / Single  
Light On with One Light Backup